

TRACK INSTALLATION ACCESSORIES:

Batten clamps are designed to rigidly attach a track to dead hung or flying pipe batten. The pipe batten acts to strengthen the curtain track and act as an intermediate support between the building structure and the track. Batten clamps may also be used to support dead hung pipe battens that hold border, leg, or masking curtains. The batten clamps fit steel pipe - not conduit or aluminum tubing used in lighting trusses. Special clamps are available to fit aluminum tubing sizes.

#1713	Batten clamp for 1" sched. 40 pipe. Plated steel 1-1/4" wide. Can be used with #1138, #1308, #1708, #2208, or #4208 track hanger. Includes 2 sets 1/4" grade 2 bolts and nuts to fasten clamp halves on pipe, but no hardware to attach to hanging clamp	\$ 6.36
#1714	Same as #1713 but for 1-1/4" sched. 40 pipe. .	\$ 7.38
#1715	Same as #1713 but for 1-1/2" sched. 40 pipe. .	\$ 8.28
#2814	Batten clamp for 1-1/4" sched. 40 pipe. Plated steel 2" wide. Can be used with #2808, #5008, #3508 track hanger. Includes 2 sets grade 2 bolts and nuts to fasten clamp halves on pipe, but no hardware to attach to hanging clamp ...	\$ 9.25
#2815	Same as #2814 but for 1-1/2" sched. 40 pipe. .	\$ 9.61
#2816	Same as #2815 but for 2" sched. 40 pipe	\$ 11.85
#HH435	Dual size batten pipe clamp of 12 ga plated steel fits 1-1/4" or 1-1/2" pipe sizes. Rated for 150 lbs working load. Includes 2 sets grade 5 bolts and nuts.	\$ 6.30
#HH435B	Same as HH435, but with black finish.	\$ 6.95

Extension Straps are used principally with #1400 cyc track when attaching the track to a *single layer* pipe grid or pipe battens above a stage or studio. Straight extension straps are used with batten clamps where track runs directly under a pipe, and twist extensions traps are used with batten clamps where track crosses under pipe(s) at right angle. Use with #4208 hanging clamp and batten clamp (not included). May also be used with other tracks and their hanging clamps. Plated steel 1-1/4" wide by 4" long with 3/8" dia holes on 3" centers. Available with black finish.

#1478	Straight extension strap.....	\$ 10.45
#1481	Twisted extension strap.....	\$ 16.00

Combo extension straps. Half the assembly is one continuous steel strap combining the batten clamp and extension strap. The other half bolts on to complete the batten clamp. Double mounting holes at the bottom match the holes in a 4208 hanging clamp.(not included) Both the straight and twisted straps are equal in length. Distance between center of pipe batten and bottom of #1400 track will be approx. 9-3/4"

#1478A	Straight combo extension strap with batten clamp for use with 1-1/2" pipe batten	\$ 15.77
#1481A	Twisted combo extension strap with batten clamp for use with 1-1/2" pipe batten	\$ 21.08

Upper/Lower Extensions can compensate for the height difference between upper and lower pipes in a two layer light grid constructed of 1-1/2" size pipes. The #HH435 batten clamp (see above) is used on pipes that are directly in line with the track. The #HH435R bracket is used on pipes that are at right angles to the track. The #HH435X straight extension strap has mounting holes 1.9" apart - the same distance as the outer dia. of a 1-1/2" size pipe. Install the #HH435X on the #HH435 or #HH435R when they are attached to the upper level of pipes

#HH435R	Right angle pipe clamp, plated 12 ga steel	\$ 10.55
#HH435RB	Black finish right angle clamp.....	\$ 11.55
#HH435X	Extension strap, plated 12 ga steel with holes on 1.9" centers	\$ 3.65
#HH434XB	Black finish extension strap.....	\$ 4.00



#1715 Batten Clamp with #4208 trackhanger



#2815 Batten Clamp with #2808 trackhanger

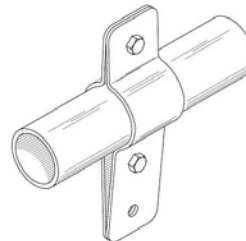

#HH435 Batten Clamp



#1478A



#1478



#1481



#1481A

See also our GHC-13 and GHC-14 grid clamps for attaching studio cyc tracks to pipe grids. These clamps can be used on both upper and lower grid pipes and with track parallel, right angle, or diagonal to the grid pipes. Track can be as close as 1" from bottom of light grid. Find them in the cyclorama track section.

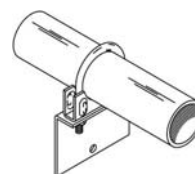

#HH435R

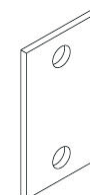

#HH435X

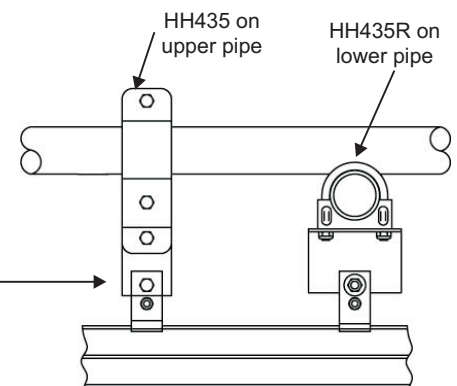

HH435 with HH435X and track hanger and HH435R with track hanger

TRACK INSTALLATION ACCESSORIES:

Threaded Rod Adapters are used to support stage curtain tracks using 3/8" or 1/2" threaded rods from the building structure.

#HH448	Rod bracket with hole for 3/8" threaded rod. Design permits approx. 2" of vertical adjustment along rod, and offset tab at bottom keeps center of gravity of the track centered on the rod. Tab has 3/8" hole for attachment of track hanger. Plated steel, size 2" w by 3/16" thick by 4-5/8" h overall. Rated for 150# working load	\$ 13.80
#HH448	Same as HH448 with black finish.....	\$ 15.16
#TSS37-3/8	Adapter for 3/8" threaded rod with offset for track hanging clamp. Plated steel approx. 2-1/2" long with hole for 3/8" bolt. Rec. working load is 150 lbs.	\$ 1.25
#TSS37-1/2	Adapter for 1/2" threaded rod <i>without offset</i> . Plated steel approx. 2-3/4" long with 5/8" dia hole for bolt. Rec. working load is 300 lbs.	\$ 2.00



#HH448 bracket with 2808 track hanger

#TSS37-3/8 rod adapter with #1708 track hanger

Adjustable Beam Clamps can attach to I-beams with a range of flange sizes. The clamps include a threaded hook rod to hold the clamp in place

#ABC-1	Fabricated of plated steel with a 3/8" dia. threaded hook rod. Include a 3/8" formed steel eyebolt and nut for attaching chain, rope, or wire rope. Max load of 300 lbs when using 3/8" threaded rod and 150 lbs when using eyebolt. Fits beam flanges from 3" to 6" wide and up to 3/4" thick.. Not recommended for heavy stage rigging.....	\$ 20.17
#ABC-2	Same as ABC-1 but with hook that fits beam flanges from 8" to 12" wide and up to 3/4" thick...	\$ 25.50
#ABC-3	Same as ABC-1 but with hook that fits beam flanges from 11" to 15" wide and up to 3/4" thick.	\$ 27.17
#CP14-1/2	Heavy duty adjustable beam clamp of 1/4" x 1-1/2" steel with a 1/2" dia threaded hook. Supports load under beam instead of at edge of flange. Fits beam flange from 3.5" to 8". Max load of 700 lbs. Has 9/16" hole in bottom for use with threaded rod (washers and nuts not incl.). May also be used with chain, rope, and wire rope (suitable fittings req.). Has factory mill finish (means dirty and oily). Available with black paint or galv. finish on special order. Larger sizes for higher loads or wider flanges are also available.	\$ 9.00

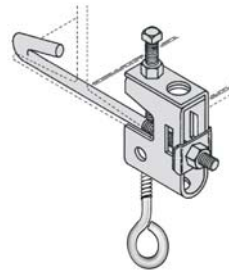

#ABC-1 Beam clamp with eyebolt

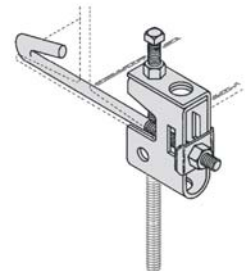

#ABC-1 Beam clamp with threaded rod

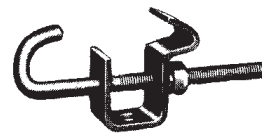

#CP14-1/2 Beam Clamp



#CP192 Beam clamp with threaded rod

Standard Beam Clamps attach to one edge of beam flange or bar-joint angle, or are sized to fit specific flange width and thickness.

#CP192-3/8	Malleable iron beam clamp for use on top or bottom flange of I-beam, c-channel, bar-joists, etc. Plated finish. For 3/8" threaded rod. Rated at 400 lbs. Fits flange thickness up to 1/2"	\$ 1.25
#CP192W-3/8	Same as #CP192 but with wide mouth to fit flange thickness up to 3/4"	\$ 3.00
#CP290	Purlin clamp is designed to fit over the vertical (max 1.5") or angled (max 2") upturned edge of a flange of a rolled steel purlin (joist). Malleable iron with mill finish. Has 3/8" threaded hole in bottom for use with threaded rod or eyebolt. Rated for 400 lbs.	\$ 7.52
#CP15-4-6	Full beam clamp fits 6" wide x 1/2" thick flange. Made of 3/8" x 2" steel with 3/4" gap between halves and 5/8" bolt. Rated for 1000 lbs. Painted black. Use with chain or wire rope. Can be used with 1/2" threaded rod by installing an eye nut. Available custom fabricated to fit other flange widths, thicknesses, and load ratings from 500 to 5000 lbs.....	\$ 22.65

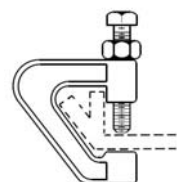

#CP290 Purlin Clamp

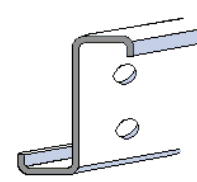

Z Purlin

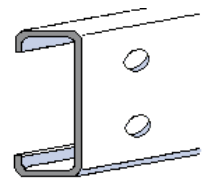

C Purlin

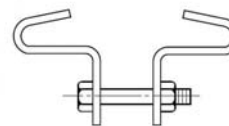

#CP15 Beam clamp